

Containers

Product Number	Product Name	Super Absorption Solidifying Agent	Flow Stopper	Quantity
DKI-RD862P-EU	Liner Bag with solidifying agent 2 Liter Pre	○		10 pcs × 5 boxes
DKI-RD862F-EU	Liner Bag with solidifying agent 2 Liter Final	○	○	10 pcs × 5 boxes
DKI-FF861-EU	Liner Bag with solidifying agent 1 Liter	○	○	10 pcs × 5 boxes
DKI-FF2863P-EU	Liner Bag without solidifying agent 3.5 Liter Pre			10 pcs × 5 boxes
DKI-FF2863F-EU	Liner Bag without solidifying agent 3.5 Liter Final		○	10 pcs × 5 boxes
DKI-RD2862P-EU	Liner Bag without solidifying agent 2 Liter Pre			10 pcs × 5 boxes
DKI-RD2862F-EU	Liner Bag without solidifying agent 2 Liter Final		○	10 pcs × 5 boxes
DKI-FF2861-EU	Liner Bag without solidifying agent 1 Liter Final		○	10 pcs × 5 boxes

Expendables

Product Number	Product Name	Quantity	Remarks
DKI-FF8453	Solidifying agent unit 3.5 Liter	50 pcs	Bag type without solidifying agent for 3.5 Liter
DKI-RD845	Solidifying agent unit 2 Liter	50 pcs	Bag type without solidifying agent for 2 Liter
DKI-FF8451	Solidifying agent unit 1 Liter	50 pcs	Bag type without solidifying agent for 1 Liter
DKI-RD900	Solidifying agent bottle FF350	30 bottles	1 bottle: 350g
DKI-RD910	Solidifying agent bottle FF130	60 bottles	1 bottle: 130g
DKI-RD888	Inlet elbow	120 pcs	White
DKI-RD841	Flow stopper	30 pcs	Overflow Protection
DKI-RD841W	Tube set with Flow stopper	30 pcs	For 1 Liter/2 Liter
DKI-FF8413	Flow stopper for 3.5 Liter	30 pcs	For 3.5 Liter

Accessories

Product Number	Product Name	Quantity	Remarks
DKI-FF707(H/L)-EU	FF Caster Set for Bag(High/Low)	1 set	Caster(High/Low) + Canister for 2 Liter Pre(3pcs) + Canister for 2 Liter(1pc)
DKI-FF708H-EU	FF Caster Set for 3.5 Liter(High)	1 set	Caster(High/Low) + Canister for 3.5 Liter Pre(2pcs)
DKI-FF765-EU	FF 1L Wall Hanging Set	1 set	Canister for 1 Liter + Hook for Canister
DKI-FF767-EU	FF 2L Wall Hanging Set	1 set	Canister for 2 Liter + Hook for Canister
DKI-FF7301-EU	Canister for 1Liter	1 pc	Bag Type for 1 Liter
DKI-RD730P-EU	Canister for 2Liter Pre	1 pc	Bag Type for 2 Liter Pre
DKI-RD730F-EU	Canister for 2Liter Final	1 pc	Bag Type for 2 Liter Final
DKI-FF7303-EU	Canister for 3.5Liter	1 pc	Bag Type for 3.5 Liter(Pre:Final)
DKI-RD792	Hook for Canister	1 pc	Wall Hanging
DKI-FF704(H/L)	Caster(High/Low)	1 stand	High/Low for Bag Type
RG-300	FitFix Regulator	1 pc	* RG-300 is not a CE marked product.
RD-822KC	Pipe Connector	1 pc	Pin Type
RD-822A	Pipe Connector	1 pc	Schroeder Type
DKI-RD886	Three way stopcock	1 pc	Suction way switch valve
DKI-RD890	Nipple with bowl valve	1 pc	Switch valve
DKI-FF794K	Trestle Set for Regulator	1 set	Trestle Set for Regulator + Silicon Tube(50cm) + Connector/Pin Type
DKI-FF794A	Trestle Set for Regulator	1 set	Trestle Set for Regulator + Silicon Tube(50cm) + Connector/Schroeder Type

● Please note that specifications and outward appearance may change without notice for enhancement purposes.



COOPDECH FitFix

(Disposable Suction Container System)

- Strong, positive and consistent suction system
- Safe handling of medical waste by conversion of liquid waste to a solid
- Remarkable Patented overflow protection system
- Greater capacity than traditional system
- Available with or without SAP(Super Absorption Particle) solidifying agent
- Compact footprint
- Faster cleanup
- Variety of configurations

 **DAIKEN MEDICAL CO., LTD.**



All products are designed and manufactured by
DAIKEN MEDICAL CO., LTD.
Made in Japan



“FitFix” SUCTION CONTAINER SYSTEM

The safest & the most widely used medical disposable suction system in Japan.

- Our patented completely closed disposable suction container system allows the most effective and the easiest way to control contamination.
- Our remarkable patented process provides the safest working environment. Unlike other well known conventional products, our system turns biological waste liquid into solid without having to open the container. Therefore, FitFix can reduce infections and create ideal and safer working environment for healthcare workers.
- The SAP(Super Absorption Particle) solidifying agent allows stable and immediate solidification of aspirated biological fluids, helping to reduce cross contamination resulting from spilling and splashing.
- Patented overflow protection system, “Flow Stopper” is one of our remarkable features. Once the fluids reach the top, “Flow Stopper” stops aspirating automatically.



Four Canisters Stand-mounted Type



Single Wall-mounted Type

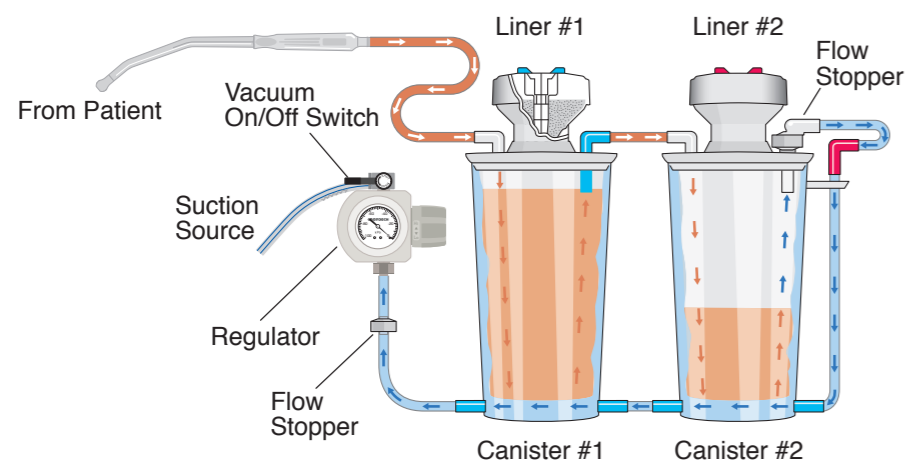

RED

Suction flows from patient to Liner #1. Once Liner #1 is filled to capacity, waste automatically spills to the next Canister (Liner #2). Flow Stopper prevents waste contamination into the vacuum system.

BLUE

Suction originates from the wall, through the regulator, to the bottom of Canister #1. Suction proceeds through a 7mm wide “U”-shaped through in Canister #1 to the bottom of Canister #2. Suction then travels through and exits the bottom of Canister #2 to the top of Liner #2. Suction travels through Canister #2 to Canister #1, then to the patient. The large volume of surface area within the outside Canisters creates our Suction System. It provides strong and consistent vacuum performance. Flow Stopper is provided to protect the vacuum system from waste contamination.

Liner Bag 1.0 L



DKI-FF2861-EU DKI-FF861-EU DKI-FF8451

Liner Bag 2.0 L



DKI-RD2862P-EU DKI-RD862P-EU DKI-RD2862F-EU DKI-RD862F-EU DKI-RD845

Liner Bag 3.5 L



DKI-FF2863P-EU DKI-FF2863F-EU DKI-FF8453

Canister

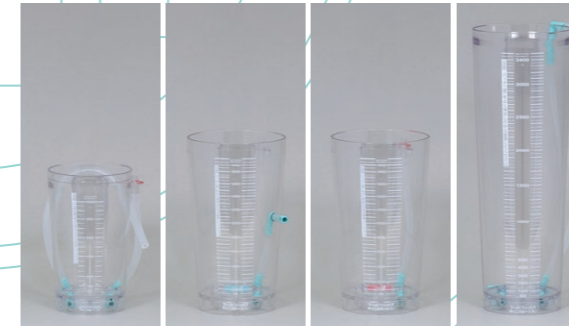

DKI-FF7301-EU DKI-RD730P-EU DKI-RD730F-EU DKI-FF7303-EU

Wall Hanging Set

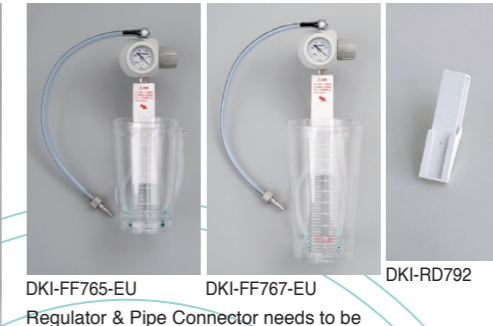

DKI-FF765-EU DKI-FF767-EU
Regulator & Pipe Connector needs to be purchased separately.

Others



①DKI-RD900 ②DKI-RD910

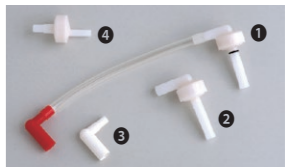

①DKI-RD841W ③DKI-RD888
②DKI-FF8413 ④DKI-RD841

FF Caster



DKI-FF707H-EU DKI-FF707L-EU DKI-FF708H-EU DKI-FF704H DKI-FF704L

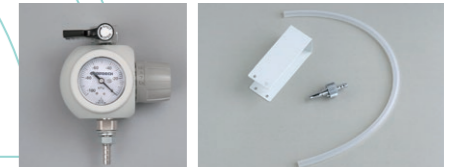

RG-300 *not CE marked DKI-FF794K(A)

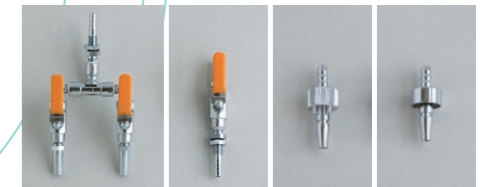

DKI-RD886 DKI-RD890 RD822KC RD822A

Assembly

Remove FitFix Liner from the package and disconnect the white end of tube set (Pre). Disconnect the red end of the tube set (Final). Fully extend the Liner. Be sure the lid of the liner seats completely around the lid of the Canister for a proper seal. Attach the white end of the vacuum tube set to the vacated “Patient” port seated next to each liner (from Pre #1 to Pre #2 to Pre #3). On the final liner which has the red colored tube set needs to be connected the vacuum source port on the Canister. Attach the vacuum tubing from the patient to the patient port on the FitFix Liner Pre #1. Apply Vacuum.



↑ Four Canisters Stand-mounted Type



↑ Single Wall-mounted Type

Disassembly for discard

Terminate the vacuum to the system. Disconnect the vacuum tubing from the patient from the FitFix Liner Pre #1 Vacuum port. Remove the white connector end & red end of the tube set from the vacuum port on the adjacent Canister and reconnect to the vacated “Patient” port on the liner to be coagulated and disposed (Pre #1,2,3 and Final). The liner is now sealed. Rotate the colored cap on top of the lid of the FitFix liner a one-quarter counter clockwise and then deeply press the colored button. This discharges the coagulants into the waste contained within the liner. Lift the liner out of the Canister and discard as per hospital policy.



↑ Four Canisters Stand-mounted Type

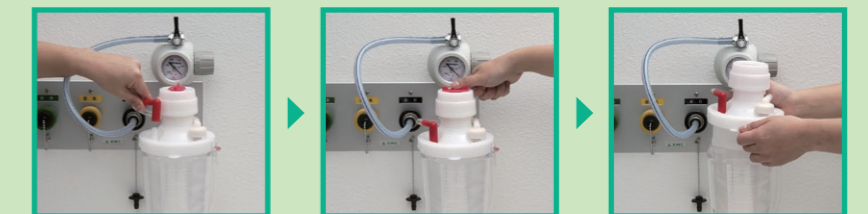

↑ Single Wall-mounted Type

Photographs shown on this paragraph are prepared for visual image. Always wear the protection gloves, masks, goggles prior to using.